



LED PANEL LIGHT

Specifications 50W UL/DLC



Led Panel Light

Technical Parameters

Part N°: HD-P612YW50W-U002

Input Voltage (V): 100-277VAC

Wattage (W): 50

PF: 0.9

Output Voltage/Current: DC27-42/1300mA

LED Type: Epistar SMD4014/SMD2835: 384PCS

CCT: 2700-3200K / 3800-4500K / 5000K

Luminous Flux: 4800lm / 5000lm / 5000lm

Light efficiency: > 95lm/W / 100lm/W / 100lm/W

CRI: ≥80

Angle(°): 120°

Dimmable Function: 0-10V dimming

Warranty: 5 years

Operating Ambient: -20 °C to +45°C, 10-80%Rh

Storage Ambient: -30°C to +65°, 10-80%Rh

Material: Aluminum+ PMMA

Certifications: UL, cUL, DLC, FCC

Net Weight: 6.5 Kgs

Dimensions: 600x1210mm

IP Code: IP40

Features

- + Extruded aluminium frame
- + Powder coated finish
- + High transparency opal polystyrene
- + Energy saving
- + High durability
- + No mercury
- + No UV/IR



Applications



OFFICE



HOSPITAL



SCHOOL



HOTEL



HOME



AIRPORT



BANK



RETAIL

© 2016 Itelecom and/or its affiliates. This document is confidential, All rights reserved.

Illumination Analysis

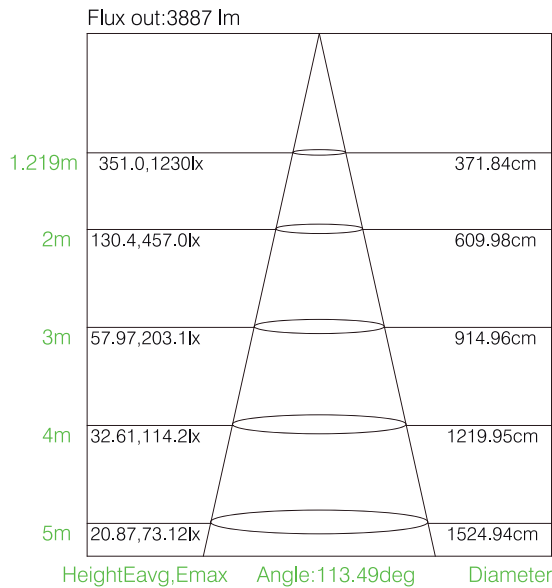

Note: The Curves indicate the illuminated area and the average illumination when the luminaire is at different distance.

Optical Property

LUMINOUS INTENSITY DISTRIBUTION DIAGRAM

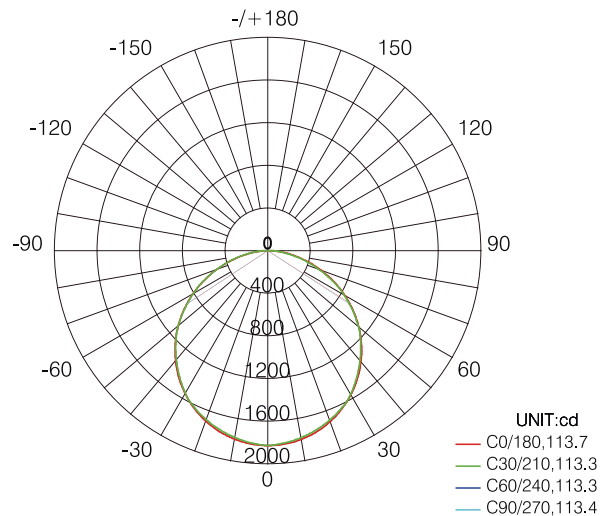

AVERAGE BEAM ANGLE(50%): 113.4 DEG

Dimensions

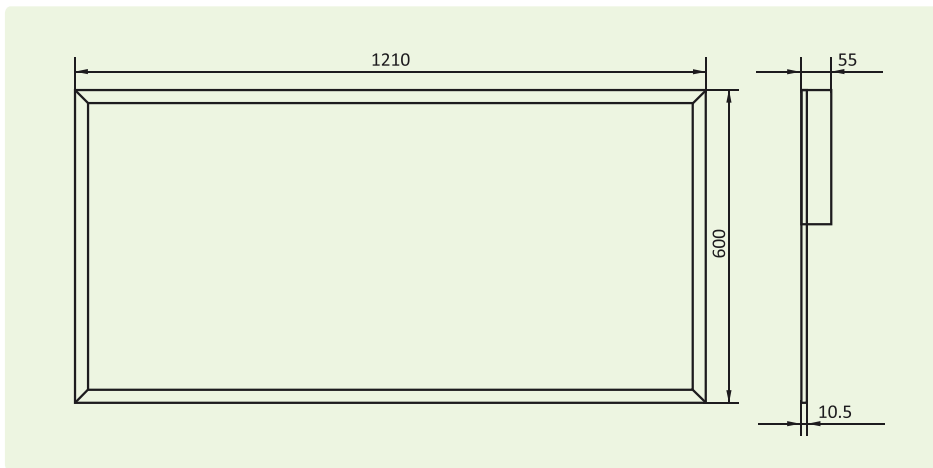

© 2016 Itelecom and/or its affiliates. This document is confidential, All rights reserved.

UL Panel Installation

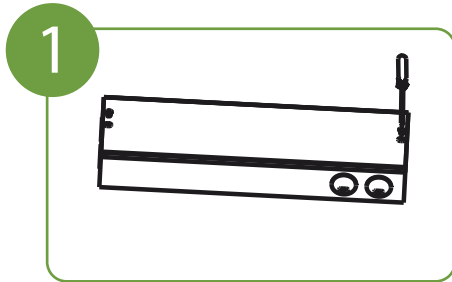

Take off the screw and open the cover

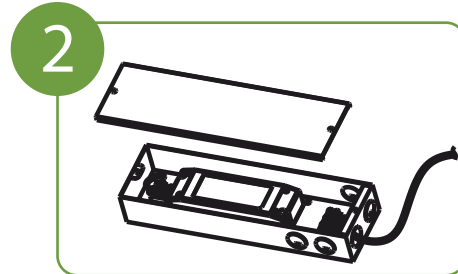

Make a hole through with a screwdriver on the driver box, then put the AC wire through the hole

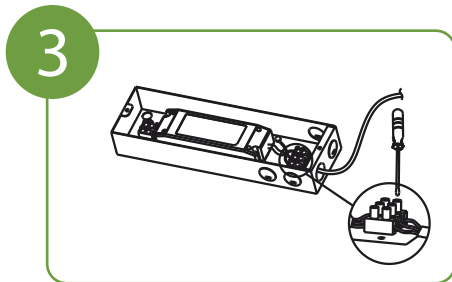

Connect the AC wire with corresponding connecting terminal, and tighten it with the screwdriver. (Blue wire is neutral wire, brown wire is live wire, yellow green is ground wire)

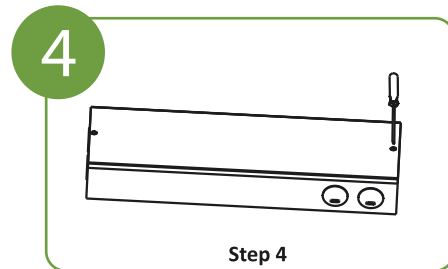

Put the cover back and fix it



© 2016 Itelecom and/or its affiliates. This document is confidential, All rights reserved.

UL Panel Installation

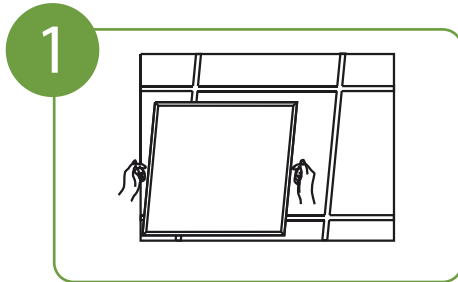

Move away ceiling panel

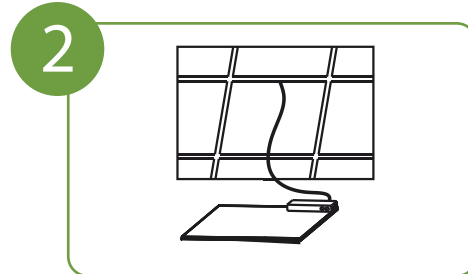

Connect power supply

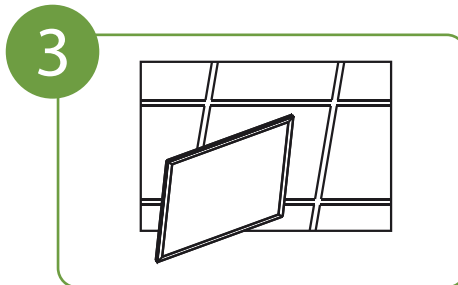

Put the panel light into framework

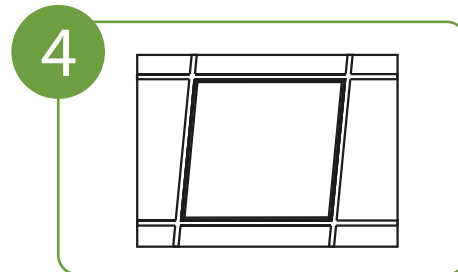

Make the panel level. Turn on the AC power to light up the LED panel light

© 2016 Itelecom and/or its affiliates. This document is confidential, All rights reserved.

goplus

by ***Itelecom.*** USA



Website: www.gopluslightingservice.com
E-mail: sales@itelecomusa.com
Ph: (305) 557.4660